



Tube end expanding
Tube end calibration after bending or
welding operations (oval tools)
Tube ring manufacture and joining
Individual use, thanks to broad diameter range

Technical data

Forming unit

- Tube diameters from 20 mm *
- Form length max. 100 mm *
- Tube wall thickness max. 4 mm *
- Axial stroke $\varnothing 70 \times 100 \text{ mm} - 9 \text{ t}$
- Expanding stroke with 5° max. in $\varnothing 17 \text{ mm}$ *
- Mean cycle duration: ~2 s

Hydraulic equipment

- Tank capacity 50 L
- Delivery capacity 13 L/min
- Pressure 240 bar
- Motor 4 kW Connection 400 V / 16 A
- Valves 230 V Bosch Rexroth

Electrical equipment

- PLC Mller Easy 230V
- Motor circuit breaker and emergency STOP
- Foot pedal

Machine structure

- Compact housing and integrated electrics and hydraulics
- Interface for vertical working position
- Compact impanding unit – incl. taper – excl. tool
- Forward stroke setting configured via hand wheel and scale
- Tube supporting table $\varnothing 210 \text{ mm}$ hardened
- Mass vertical variant L = 1070; W = 530; H = 925 mm
- Emissionsound pressure level: 72 dB (A)
- Colour of housing – Ral 5010 gentian blue
- Colour of expanding unit – burnished black
- Weight approx. 350 kg

Options

- Choice of colour
- Pulse control (minimising of segment gap marks)
- Siemens electrical equipment (pulse control inclusive)
- Emergency Stop via safety relay
- Connection without neutral conductor
- Single piece counter
- Axial stroke $\varnothing 100 \times 100 \text{ mm}$ 19 t (up to +100% cycle duration)
- Horizontal variant L = 760; W = 550; H = 1120 mm
- Tube support table $\varnothing 480 \text{ mm}$ plastic
- Tube support table $\varnothing 1000 \text{ mm}$ galvanised steel
- Carrier tool for plastic tools $\varnothing 60 \text{ mm}$
- Carrier tool for steel attachment tools $\varnothing 70 \text{ mm} - 14 \text{ mm}$ path
- Carrier tool for steel attachment tools $\varnothing 70 \text{ mm} - 17 \text{ mm}$ path
- Quick-change flange for basic tools
- Return stroke limitation via hand wheel with scale
- Punching unit



TUBEX

EASY

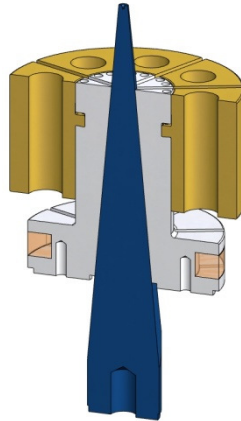

Working head rotated 90°



Horizontal



Support table Ø 480 mm