



Tube end impanding (reduction)
Tube end calibration after bending or welding operation
Tube ring manufacture and joining
Individual use, thanks to broad diameter range

Technical data

Forming unit

- Tube diameters from 10 – 140 mm *
- Form length max. 100 mm *
- Tube wall thickness max. 4 mm *
- Axial stroke Ø 100 x 100 mm – 19 t
- Impanding stroke in Ø 14 mm *
- Mean cycle duration: ~4 s

Hydraulic equipment

- Tank capacity 50 L
- Delivery capacity 13 L/min
- Pressure 240 bar
- Motor 4 kW Connection 400 V / 16 A
- Valves 230 V Bosch Rexroth

Electrical equipment

- PLC Möller Easy 230V
- Motor circuit breaker and emergency STOP
- Foot pedal

Machine structure

- Compact housing and integrated electrics and hydraulics
- Interface for vertical working position
- Compact impanding unit
- Forward stroke setting configured via hand wheel and scale
- Carrier tool for steel attachment tool
- Dimensions vertical var. L = 1070; W = 530; H = 925 mm
- Emissionsound pressure level: 72 dB (A)
- Colour of housing – Ral 5010 gentian blue
- Colour of impanding unit – burnished black
- Weight approx. 450 kg

Options

- Choice of colour
- Pulse control (minimising of segment gap marks)
- Siemens electrical equipment (pulse control inclusive)
- Emergency Stop via safety relay
- Connection without neutral conductor
- Single piece counter
- Horizontal variant L = 950; W = 530; H = 1450 mm
- Tube diameter 190 mm
- Return stroke limitation via hand wheel with scale



TUBIN

EASY

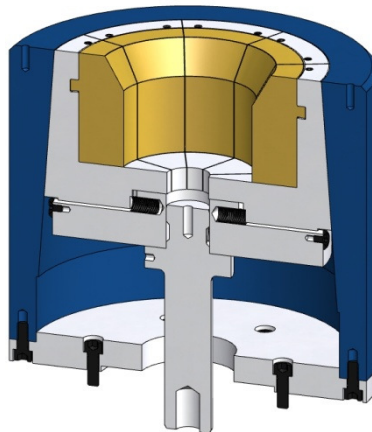

Horizontal